

Fasteners to ensure that the system efficiency will be equivalent to the filter efficiency

The C-81-2 or C-81-4 prefilter fastener inserts into a cavity integral to the Durafil ES frame for face mounting a 2" or 4" prefilter.

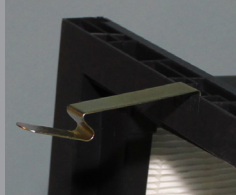

C-70 fastener securing the header of a Camfil HiFlo, the same fastener may be applied to any 1" nominal size headered air filter.



Fasteners are available for Camfil holding frames and housings, or for other manufacturers air filter mounting systems. Our fasteners are designed to ensure that your system air quality is equivalent to the highest level of your system's filter efficiency. Each fastener contributes to an air tight seal between the mounting mechanism and the air filter (requires the appropriate sealing gasket on the filter or the filter mounting mechanism).

Constructed of high-tensile strength metals Camfil fasteners are unchallenged by the repeated rigors of filter change and maintenance. For challenging environments most fasteners can also be manufactured from alternate materials such as stainless steel, contact factory for more information.

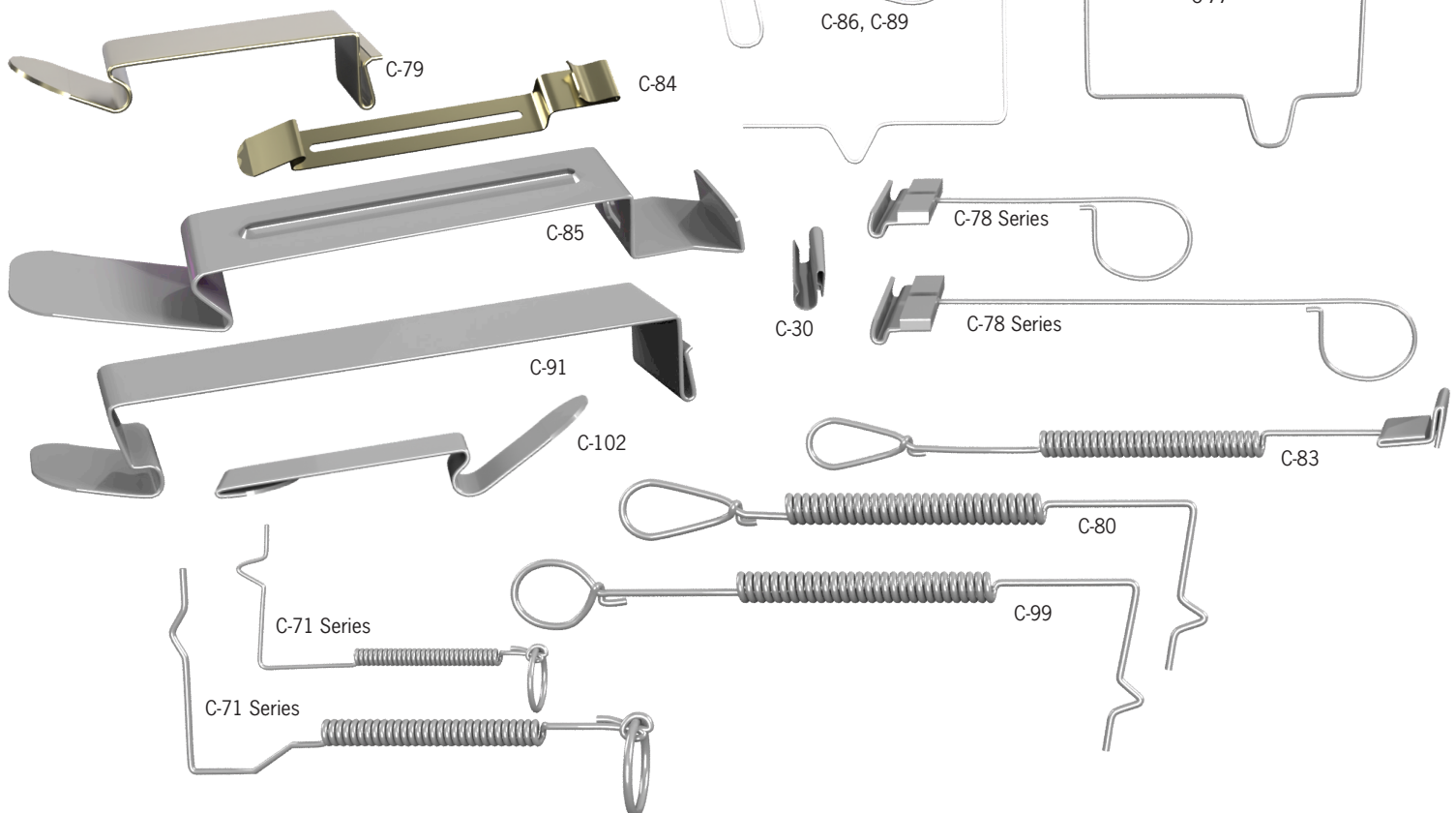

Camfil Fasteners and Clips for Securing Filters in Frames and Housings

Filt	Access Availability		Model Number	Description	Part Number
	Upstream	Downstream			
30/30, Dual 9, Aeropleat, Opti-Pac, Opti-Pac Durable, and CityPleat in Camfil Type 8 Holding Frame	●	●	C-70	1" or 2" deep filter	050025-000
	●		C-86	4" deep filter (use C-77 for Opti-Pac)	074437-000
	●	●	C-77		059615-001
	●		C-79-1	2" deep filter as a prefilter to a Durafil ESB, Riga-Flo, or Aeropac (no header)	061179-001
	●		C-79-2	4" deep filter as a prefilter to a Durafil ESB, Riga-Flo, or Aeropac (no header)	061179-002
	●		C-81-2	2" deep filter as a prefilter face-mounted in the same frame with the Durafil ES	406110-002
	●		C-81-4	4" deep filter as a prefilter face-mounted in the same frame with the Durafil ES	406110-004
	●		C-79-5	4" deep Opti-Pac with 2" deep prefilter	061179-005
	●		C-79-6	4" deep Opti-Pac with 4" deep prefilter	061179-006
	●		C-102-1	2" deep filter as a prefilter to a Riga-Flo E-Series (no header)	124298-001
	●		C-102-2	4" deep filter as a prefilter to a Riga-Flo E-Series (no header)	124298-002
	●		C-704	1" deep filter as a prefilter in the same frame with Hi-Flo, Riga-Flo PHA or Aeropac (single header)	050025-000
	●		C-86 or C-77 & C-70	2" deep filter as prefilter in the same frame with Hi-Flo, Durafil ES, Riga-Flo PHA or Aeropac (single header) (Two C-70 should be used to hold headered filter in place, and two C-86 fasteners (or C-77) should be used to hold prefilter in place. Fasteners would be on opposite corners).	074437-000
	●				059615-001
	●				050025-000
	●		C-89 & C-70	4" deep filter as a prefilter in the same frame with Hi-Flo, Riga-Flo PHA or Aeropac (single header)	078865-000
	●		C-103-1	2" deep filter as a prefilter in the same frame with Aeropac (double header)	403229-001
	●		C-103-2	4" deep filter as a prefilter in the same frame with Aeropac (double header)	403229-002
30/30, Aeropleat, Hi-Flo, Riga-Flo, Opti-Pac in Competitive Holding Frame	●	●	C-78-1	1" deep filter	059920-001
	●	●	C-78-2	2" deep filter	059920-002
	●	●	C-78-4	4" deep filter	059920-003
	●		C-78-2	1" deep filter as a prefilter to a Hi-Flo or Riga-Flo PHA	059920-002
	●		C-78-3	2" deep filter as a prefilter to a Hi-Flo or Riga-Flo PHA	059920-004
	●		C-78-5	4" deep filter as a prefilter to a Hi-Flo or Riga-Flo PHA	059920-006
	●		C-78-7	2" deep filter as a prefilter to a Opti-Pac	059920-008
Riga-Flo in Camfil Type 8 Holding Frame	●	●	C-80 or C-99	To secure 12" deep filter — 24" x 24"	061180-000
	●	●			114353-000
	●	●	C-80 or C-99	To secure 12" deep filter — 24" x 12"	061180-000
	●	●			114353-000
	●	●	C-90	To secure 6" deep filter — 24" x 24"	078948-000
	●	●	C-90	To secure 6" deep filter — 24" x 12"	
	●		C-91	To secure 6" deep filter as a prefilter to a 12" deep filter—24" x 24"	079445-000
	●		C-91	To secure 6" deep filter as a prefilter to a 12" deep filter—24" x 12"	
Aeropac7, Durafil, Riga-Flo PH, Hi-Flo In Camfil Type 8 Holding Frame	●	●	C-80 or C-99	To secure 12" deep Aeropac (no header) — 24" x 24", 24" x 12"	061180-000
		●	C-70	To secure a single header pocket style filter (Hi-Flo)	050025-000
	●	●	C-70	To secure a 12" deep single header style filter (Riga-Flo PH, Durafil, Aeropac)	050025-000
	●	●	C-100	To secure a 12" deep single header Aeropac style filter	114646-000
	●		C-80 or C-100	To secure a 12" deep double header style filter	061180-000
	●	●	C-70	To secure 6" deep single header style filter	050025-000
	●	●	C-90		078948-000
Durafl ES3 Box (FSB & USB)	●		C-85-2	2" deep filter as a prefilter to a Durafil ES3 Box (FSB & USB)	850700367
	●		C-85-4	4" deep filter as a prefilter to a Durafil ES3 Box (FSB & USB)	850700368
Notes	<ol style="list-style-type: none"> When using the Farr 30/30 Class 1 filter in this application, a C-77 fastener should be used. Two fasteners can be used for upstream application, however it is not recommended. C-99 is also available in place of the C-80 to allow for more clearance downstream. To secure a Riga-Flo PH or Durafil using upstream access only, use a C-70 fastener, part number 050025-000. For the Durafil only, the C-70 fastener may be used on the downstream as well. For upstream access & downstream access (Durafl and Aeropac only) where the filter goes through frame opening a C-70 fastener should be used. When the filter does not go through the frame opening then a C-80 or a C-100 (Aeropac only). 				

© Copyright Camfil Air Filter Fasteners 061025

